



Educator Guide to Lexia® English Student Program Screens

Lexia® English Language Development™ is an adaptive blended learning speaking and listening program that supports students' English language development through academic conversations.

How to use this guide

The following visuals will help you monitor your students' progress as they are working in the Lexia English program. They may also be used to illustrate how students can self-monitor and record their own progress, such as completing Achievement Charts or the Student Goal Setting Worksheets available in the Lexia English Resources Hub.

You may wish to print and display these visuals wherever the student program is being utilized.

Objectives

This guide will help educators:

- navigate the various Lexia English student program screens
- monitor progress in the Lexia English student program

Survey

Please take some time to consider how this resource has helped to make your students' experience with Lexia® English Language Development successful. Let us know how it went by scanning the QR code to complete a two-minute survey. You can also access the survey by clicking [here](#).





C



Welcome, Dave C.

This Week: 5 27



B

A



D

D

Level 7



Program Screen

- A Usage display:** Track the total minutes and units completed in the program this week (Monday – Sunday).
- B Microphone button:** Click the microphone and say, “Let’s go!” to continue working in the program.
- C Student avatar:** When first logging in, students create a personalized representation of themselves that appears throughout the program.
- D Program level:** View the current level number.
- E Logout button:** Log out of the student program.
- F Student information button (small):** Display student progress, settings, and the logout button.
- G Volume:** Click on the icon to adjust the program volume.
- H Information Apple button:** Access the Quick Tips for Microphone Setup & Use.



Level Screen

- A Level progress bar:** View the current level and activity badges earned for each completed activity.
- B Activity:** Click on a character to enter an activity (begin with four characters per level).
- C Topic:** Each activity is focused on a specific subject area (Science, Geography, Math, or General Knowledge/Biographies).
- D Activity progress meter:** A progress meter fills in as encounters in the activity are completed.
- E Back button:** Return to the Program Screen.
- F Student information button:** Display student progress, settings, and the logout button.



Jason M.



B

Units



Farah

Activity Screen

- A Encounter:** View the remaining encounters in this activity (begin with three per activity).
- B Encounter progress meter:** A progress meter fills in as units are completed.
- C Character fun facts:** Click the speech bubbles to hear about each character's unique background and heritage.
- D Encounter progress bar:** Each encounter badge represents an encounter completed in this activity.
- E Microphone button:** Click the microphone and say, "Let's go!" to continue working in the encounter.
- F Back button:** Return to the Level Screen.

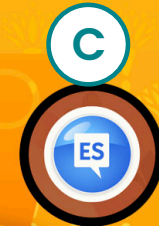
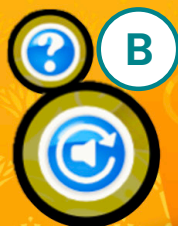
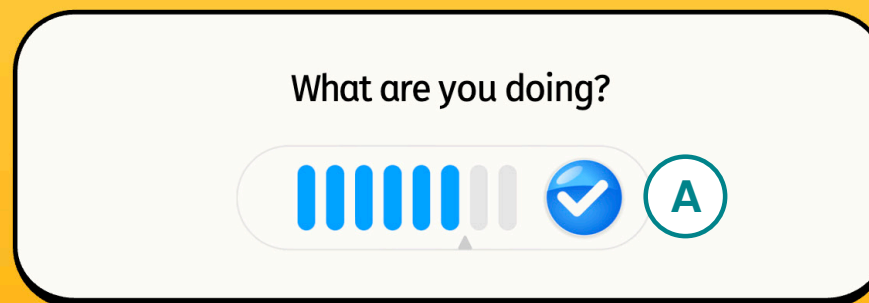

Unit Screen

- A Microphone meter:** Click the microphone button when ready to speak. When the microphone meter appears, the program is listening.
- B Rehear buttons:** Hear the character say the directions, word, sentence, or passage again.
- C Language Support:** The directions and media units in Levels 1-4 may be translated into Spanish if enabled in myLexia.
- D Unit meter:** Each green rectangle in the progress meter represents a unit completed in this encounter.
- E Unit rounds:** Each green dot represents a round completed in this unit. Complete all unit rounds before logging out of the program.
- F Back button:** Return to the Level Screen.
- G Student information button:** Display student progress, settings, and the logout button.

Click the student information button from any program screen to display this menu and access the following options.





Hilary W.

A Level 3 | Sarika | Encounter 2 | Unit 5

B Level Certificates

1	2	3	4	5	6
7	8	9	10	11	12
13	14	15	16	17	18
19					

Default - Jack Mic (Realtek(R) Audio)

C Change

D Log Out

Student Information

- A Student Position:** View the student's current position in the program.
- B Level Certificates:** Access student certificates for each completed level.



- C Select Microphone:** View or change the device's active microphone. A headset microphone may appear as a USB audio device or as a generic input device.

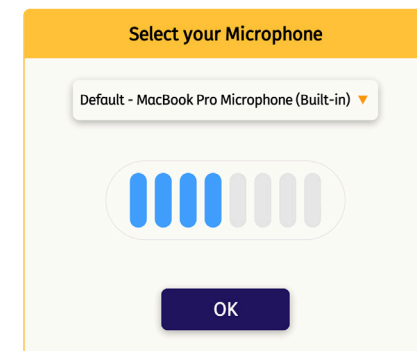

- D Logout button:** Log out of the student program.

Quick Tips for Microphone Setup & Use



- Ensure students use wired headsets with microphones

- USB microphone and noise-canceling headphones
- 3.5mm jack with microphone and noise-canceling headphones



- Demonstrate how to correctly wear and use headsets

- Encourage students to speak clearly; avoid whispering or speaking too loudly

- Verify the correct microphone has been selected by checking the user settings

- HINT: If microphone selection list shows the same microphone multiple times, try each one until you see the meter moving

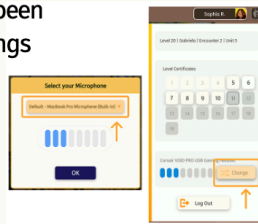

- Ensure microphone button is unmuted

- Check the F buttons in the top row of the keyboard to ensure the mute button has not been enabled, typically F4 or F5



- Limit background noise

- Obtain additional support when needed

- Follow up with your school district's IT specialist
- Refer to the **Technical Assistance Guide** in the **Lexia English Resources Hub** for directions to contact the Lexia Support Team



A

L03.A04.E01.U02_ConvoA.R01
Support ID: OsX2ziXX9XCrm7wA1LKhs

B



Information Apple

Teachers can click the information apple button from any program screen to display the tips for microphone setup and access the following options.

A Student Position: View the student's current position in the program.

B Support ID: Follow up with Lexia® Support using a unique identification number.

C Settings button: Review account information, student privacy statement, license agreements, and notices.

D Support button: Submit important technical information to Lexia Support.

Support
X

To help debug problems, this will send your technical information to Lexia®. You must contact support for next steps, along with capturing the Support ID.

Cancel
Send